



## Data sheet

### Hydraulic data

Maximum operating pressure $P_N$	1 bar
Min. fluid temperature $T_{\min}$	5 °C
Max. fluid temperature $T_{\max}$	35 °C
Min. ambient temperature $T_{\min}$	5 °C
Max. ambient temperature $T_{\max}$	40 °C
Max. fluid temperature, for short periods up to 5 min $T$	35 °C
Sound-pressure level	48.1 dB
Switching volume $V$	0.7 l
Macerator	no

### Motor data

Mains connection	1~230 V, 50 Hz
Rated current $I_N$	1.22 A
Protection class	IP44
Phase	1
Rated speed $n$	2900 1/min
Number of poles	2
Activation type	Direct On Line (DOL)
Max. switching frequency $t$	100 1/h
Power consumption $P_1$ (Q=max.) of selected impeller * number of pumps $P_1$	250 W
Insulation class	F

### Materials

Pump housing	PP-GF30
Impeller	PA66-GF15
Motor housing	PP-GF30

### Installation dimensions

Pipe connection on the suction side $DN_s$	DN 40
Pipe connection on the discharge side $DN_d$	DN 32

Pump curves

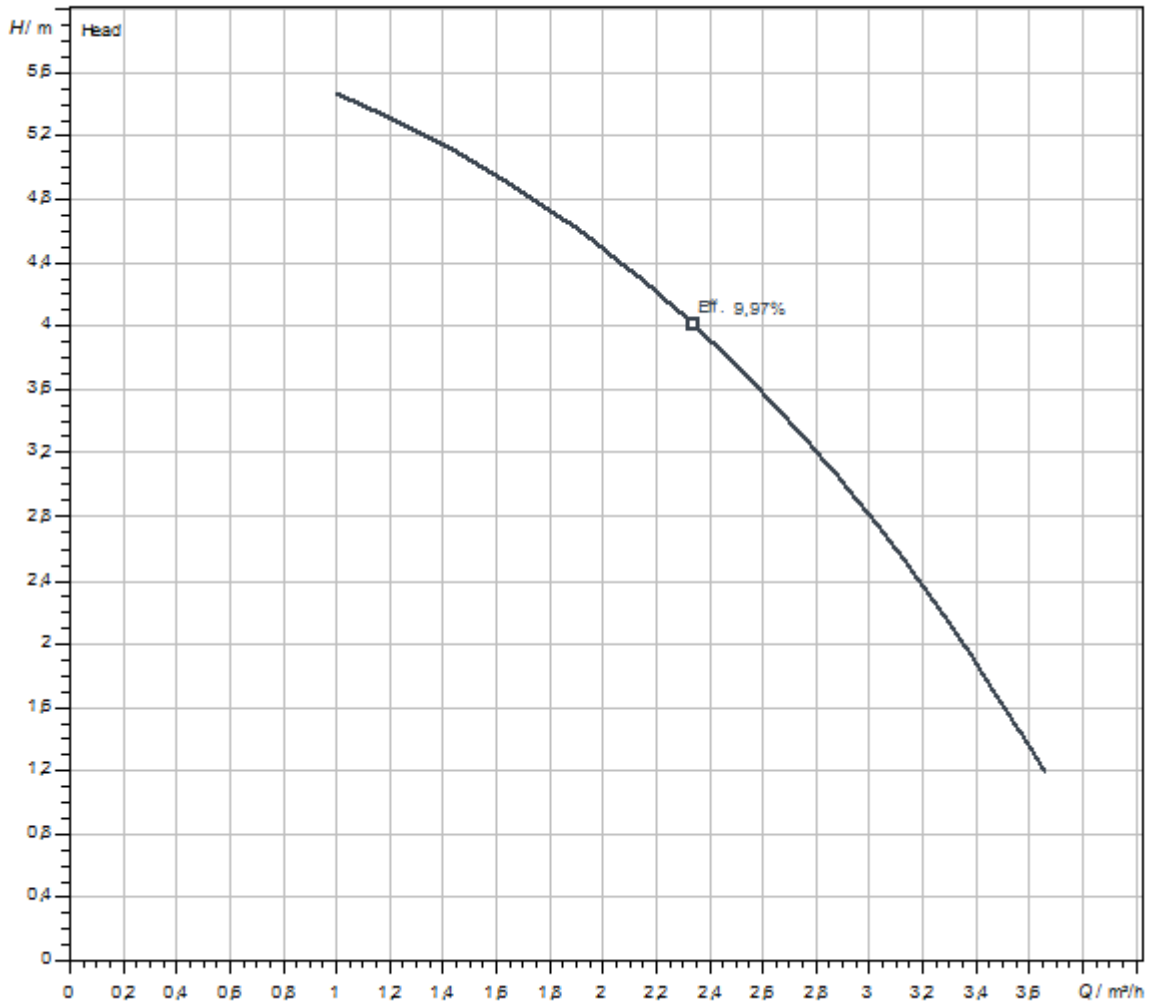

Fluid media	Water 100 %
Fluid temperature <i>T</i>	20,00 °C
speed at duty point <i>n hydr. @ OP</i>	2.876 1/min

Dimensions and dimensions drawings

HiDrainlift 3-24

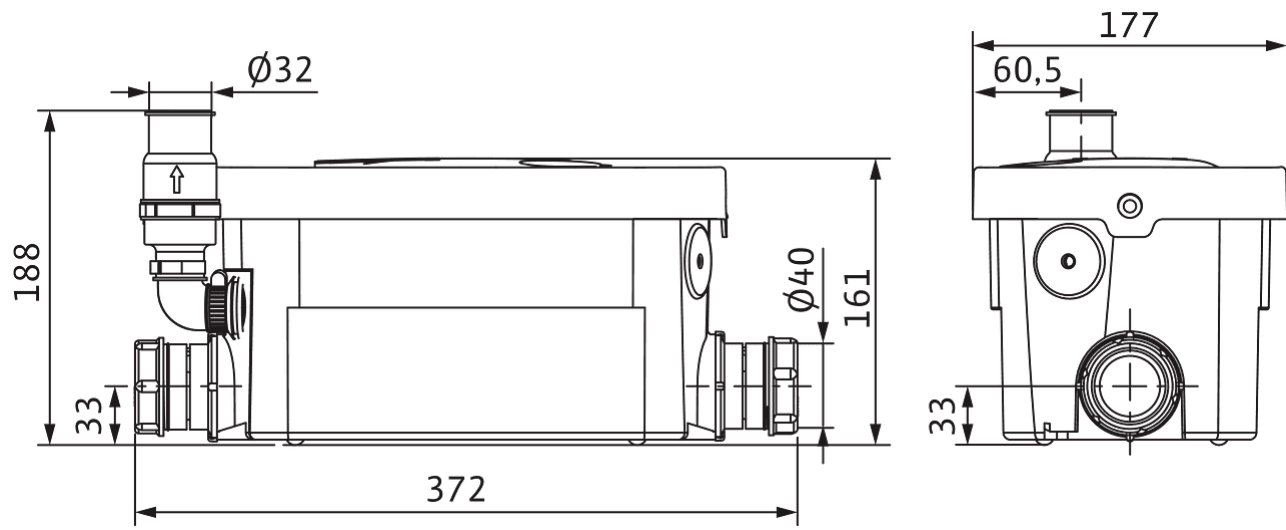

## Tender text

Very compact, low-noise and automatic wastewater lifting unit in accordance with EN 12050-2, for installation under a shower or in floor units, with all required switching and control equipment.

## Components of the system:

- > Reliable submersible pump
- > Built-in non-return valve
- > Active carbon filter
- > Overflow protection
- > Flexible connecting piece

Up to two connection options for drainage of wash basin, shower or bidet.

Local standards and directives (e.g. DIN 1986 in Germany) must be complied with during construction work.

A mains-dependent alarm is available as an option.

## Operating Data

### Approved field of application

Fluid temperature $T$	5 °C
Max. fluid temperature, for short periods up to 5 min $T$	35 °C
Ambient temperature $T$	5 °C
Maximum operating pressure $PN$	1 bar

### Motor data

Mains connection	1~230 V, 50 Hz
Voltage tolerance	±10 %
Rated power $P_2$	0.25 kW
Rated speed $n$	2900 1/min
Rated current $I_N$	1.22 A
Insulation class	F
Protection class motor	IP44
Max. switching frequency $t$	100 1/h

## Materials

Tank	PP
Pump housing	PP-GF30
Impeller	PA66-GF15

## Installation dimensions

Pipe connection on the suction side	DN40
Pipe connection on the discharge side	DN32

## Ordering information

Brand	Wilo
Product description	HiDrainlift 3-24
Net weight, approx. $m$	3.6 kg
Article number	<b>4191678</b> 

Electrical accessories

Alarm signal

---

AlarmControl

AlarmControl 1	2522846	EUR 202.-
AlarmControl 2	2522847	EUR 211.-

---

Small alarm switchgear

Small alarm switchgear KAS	501534094	EUR 406.-
----------------------------	-----------	-----------